

Jewish Museum, London

project	Jewish Museum
location	Camden Town, London
client	The Trustees of the Jewish Museum London
dates	2003- 2010
cost	£7.5 million

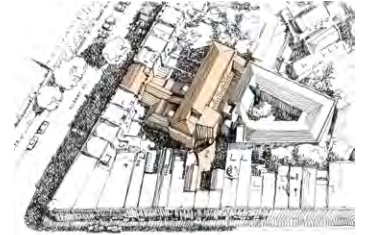

The Jewish Museum formerly operated out of two London sites in Camden Town and Finchley. They have since acquired a Victorian factory building in the middle of the block backing onto their Camden Museum, which is in a Listed terrace House.

Long and Kentish were appointed through SOJEU procedures to carry out a major renovation/ restoration project linking the two buildings to form an important new Museum containing a designated collection of Jewish ceremonial art, and bringing on site the Finchley collections dealing with Jewish life in Britain.

The project was supported by HLF funding. The exhibition design was carried out by Events Coordination Ltd.

The museum opened in 2010.

